

## Attachment of locator and jig

- In the case of attaching the locator and the jig on the chuck body surface, tap or drill a hole in the additional process range specified in Fig. 12.

Shaded part additional process possible range

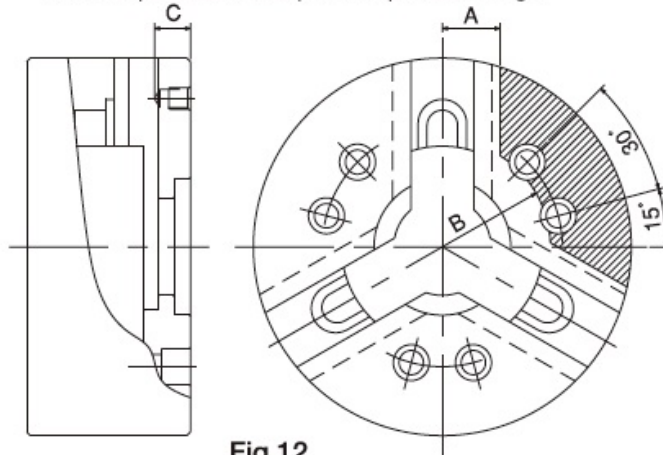

Fig.12

Table 4

Type	A (mm)	B (mm)	C (mm)
B-15	51	107	Less than 30
B-18	53	107	Less than 30
B-21	53	135	Less than 30
B-24	53	150	Less than 30

A, B: Additional process impossible dimension.

C: Processible depth of tapping or drilling a hole.

**⚠ DANGER**

- The chuck can be modified only in the manufacturer permissible range. This will not only break the chuck but the chuck and work may fly out, which is dangerous.
- Provide a countermeasure against flying out (dwell pin, etc.) due to centrifugal force to the locator or the jig, and attach with bolts which have sufficient strength. The locator or the jig may fly out, and this is dangerous.